

CIERRE MECÁNICO TIPO: CMFL65

ALTA
TEMPERATURA

Datos Técnicos:
Usa juntas de Grafoil.
Equilibrado.
Estacionario.

MATERIALES:

Acero Inoxidable 316
Hastelloy c-276
Monel K-500
Alloy 20
Carbón Grafitado
Carburo de Tungsteno
Carburo de Silicio



LIMITES DE OPERACIÓN:

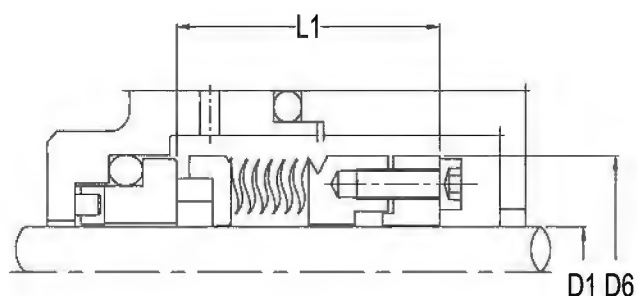
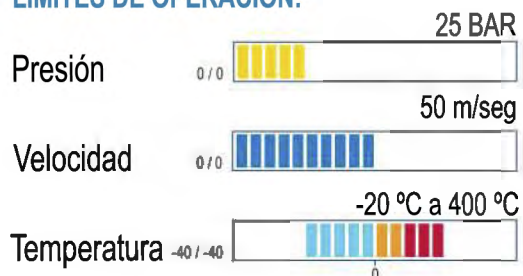

d_1	d_2	d_3	d_4	d_5	d_6	L_1
16-19	20.5	29	30.3	25.3	45.0	33.5
20-24	25.5	35	38.8	33.8	49.0	33.5
25-30	31.5	40	43.6	38.6	55.0	34.5
31-35	36.0	45	45.8	40.8	59.0	33.0
36-40	41.0	50	51.5	46.5	65.0	30.5
41-45	46.0	55	55.2	50.2	69.0	35.5
46-51	52.0	63	64.7	59.7	76.5	40.5
52-60	61.0	70	70.6	65.6	84.0	32.0
61-70	71.0	80	82.8	76.8	95.0	38.0
71-82	83.5	95	98.0	92.0	112.0	41.0
83-88	89.5	100	107.7	101.7	120.0	47.0
89-100	101.0	112	112.7	106.7	130.0	47.0